

DeckWise<sup>®</sup>, The Ipe Clip<sup>®</sup> Fastener Company, LLC • 2111 58th Ave. E, Bradenton, FL 34203  
Tel: 941-896-9851 • Toll Free: 866-427-2547 • info@DeckWise.com • www.DeckWise.com



**Warning:** To reduce the risk of injury, read and understand the operator's manual for your power tool before use. Always wear eye protection.

- **Anti-Skate Design**
- **Extra Sharp Cutting Teeth**
- **Job Site Convenience**



### STEP 1 - Attach to Drill

Attach to any hand-held electric or battery powered drill.

*Note: Can also be used with a drill press*

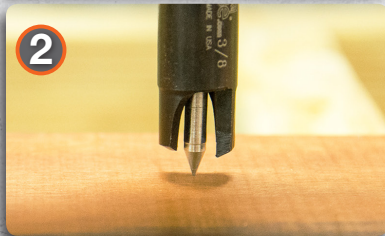

### STEP 2 - Insert Point

Remove the plastic pin protective cover. Insert retractable point into wood.



### STEP 3 - Cut Plug

Secure the scrap piece of wood you will be cutting the plugs out of with a clamp. Slowly increase the drill speed until the teeth begin to cut and then increase to max speed until you have reached a depth of about 3/8".

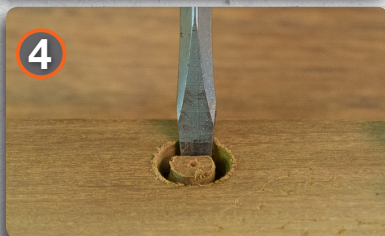

### STEP 4 - Remove Plug

Snap the plug free by inserting a flat head screwdriver or a small chisel in the cut and push it against the plug along the grain. Snapping against the grain results in the plug breaking uneven and too short to use.